

CERTIFIED RECORD OF LAND CORNER MONUMENTATION

R-8

History of original corner establishment:

Corner position established by James Hanley in 1878, Grant Co. survey No. 71.
Set 5/8" x 30" rebar.

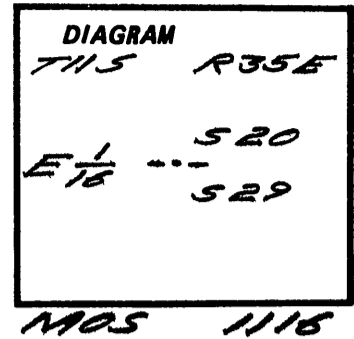

Description of corner evidence found:

5/8" iron rod with yellow plastic cap marked RPE 2808 brs. N00°01'48"W 40.52'

Established true corner position based on closed & balanced traverse performed in Aug. 1989.

Description of monument and accessories I established to perpetuate the original location of this corner: Set 2 1/4" x 30" aluminum pipe with 2 1/2" aluminum cap rising 5".

Cap marked

BTs
8" PP brs. N53°E 13.6'
marked E 1/16 520 BT
9" LP brs. S37°E 23.0'
marked E 1/16 529 BT

E 1/16 --- 520
529
1989
LS1020

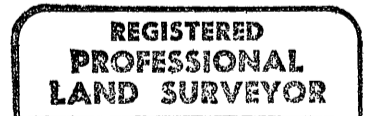

I hereby certify the above corner was established as described in Oct. 1989.

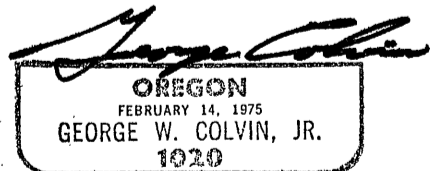

Office of County Surveyor County of Grant
State of Oregon, I hereby certify that the within instrument was filed in this office for record on the 1 day of Dec, 1989
Robert D. Baggett by _____
(COUNTY OFFICIAL) (DEPUTY)